

5/20/2019 1:50 PM PLOTTED BY: BYRON CHRISTIAN PLOT STYLE: 2018POLARIS_R02CTB PLOTTING DEVICE: ADOBE PDF P:\NGC - BELIZE PE 18-354 - NGC BIG CREEK LANDING TERMINAL\CIVIL_STRUCTURE\PIPE18-354-CS-PP-01.DWG

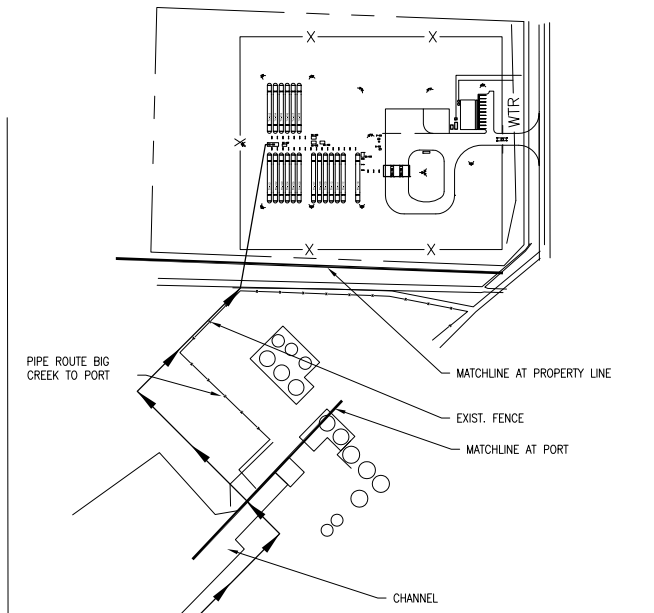
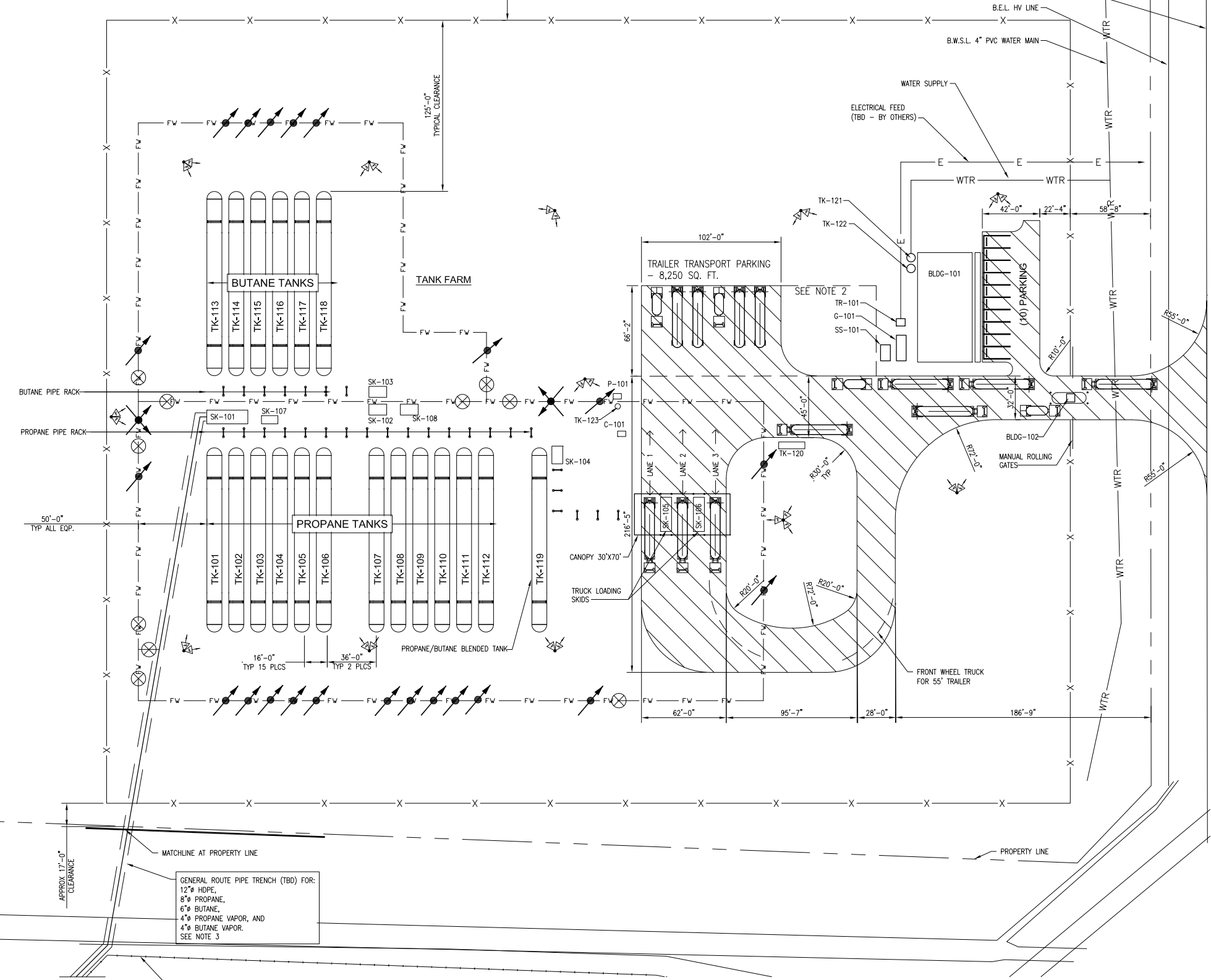

- KEY PLAN**
NOT TO SCALE
- LEGEND**
- ASHALT PAVEMENT
47,711 SQ. FT.
 - POST INDICATOR VALVE (QTY 10)
 - FIRE MONITORS (QTY. 22)
 - FIRE MONITORS - OSCILLATING (QTY. 2)
 - AREA LIGHTING - LIGHT POLE SHOWN
SEE NOTE 1
 - CHAIN LINK FENCE (2,583 LIN. FT.)
 - WATER (145 LIN. FT)
 - FIRE WATER (2,007 LIN. FT)
 - ELECTRICAL
 - PROPERTY LINE

EQUIPMENT LISTING

TAG #	DESCRIPTION	ESTIMATE SIZE
SK-101	LIQUID PROPANE & BUTANE VESSEL UNLOADING SKID	30' X 10'
SK-102	LIQUID PROPANE PUMP SKID	13' X 8'
SK-103	LIQUID BUTANE PUMP SKID	13' X 8'
SK-104	LIQUID PROPANE & BUTANE BLENDED PUMP SKID	13' X 8'
SK-105	LIQUID PROPANE & BUTANE BLENDED DUAL SIDED TRUCK LOADING SKID	25' X 8'
SK-106	LIQUID PROPANE SINGLE SIDED TRUCK LOADING / LIQUID PROPANE OR LIQUID PROPANE & BUTANE BLENDED UNLOADING SKID	25' X 8'
SK-107	MERCAPTAN/ODORANT INJECTION SKID	12' X 6'
SK-108	LIQUID PROPANE & BUTANE BLENDING SKID	13' X 8'
BLDG-101	CONTROL ROOM & OFFICE BUILDING	40' X 80'
BLDG-102	GUARD SHACK	6' X 6'
G-101	BACK-UP GENERATOR	12' X 8'
SS-101	SEPTIC SYSTEM	12' X 8'
TR-101	ELECTRICAL TRANSFORMER	3' X 3'
C-101	INSTRUMENT AIR COMPRESSOR	6' X 4'
P-101	FIRE WATER JOCKEY PUMP (ELEC)	3' X 2'
TK-101 THRU TK-112	PROPANE STORAGE TANKS (90,000 GALLON TANK)	135' X 10' X 11'
TK-113 THRU TK-118	BUTANE STORAGE TANKS (90,000 GALLON TANK)	135' X 10' X 11'
TK-119	BLENDED PROPANE AND BUTANE STORAGE TANK (90,000 GALLON TANK)	135' X 10' X 11'
TK-120	DIESEL FUEL STATION (3,000 GALLON)	18' X 6' X 5'
TK-121	WATER TANK (3,000 GALLON)	8'D X 9'H
TK-122	WATER TANK (3,000 GALLON)	8'D X 9'H
TK-123	FIRE WATER - JOCKEY PUMP TANK (500 GALLON)	4'D X 6'H

- NOTES**
- NUMBER OF LIGHTS BASED ON SEPARATION / LOCATION CONFIGURATION(TBD - ON HOLD)
 - TRUCK PARKING LOT AND LOCAL AREA FOR TEMPORARY LAYDOWN YARD
 - PIPE TRENCH OFFSITE (ESTIMATED 40'x5') FOR FUTURE (2 LANE WIDE ROAD W/ 6' WIDE DITCH BOTH SIDES.

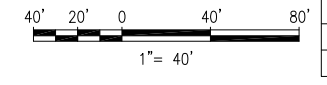
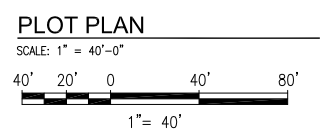

REV.	DATE	BY	CHK.	POLARIS CLIENT APPROVED	REVISION DESCRIPTION
	05/2019	BDC	RJC		REVISED FOR DESIGN
	04/2019	GFM	BDC	RJC	ISSUE FOR DESIGN



NATIONAL GAS COMPANY (BELIZE) LTD. BIG CREEK LANDING TERMINAL			
CIVIL PLOT PLAN			
BY: GFM	SCALE: AS NOTED	PROJECT NO. PE18-354	REV.
CHKD.: BDC	DATE:	DRAWING NUMBER PE18-354-CS-PP-01	B